

ALL DIMENSIONS ARE IN MM.

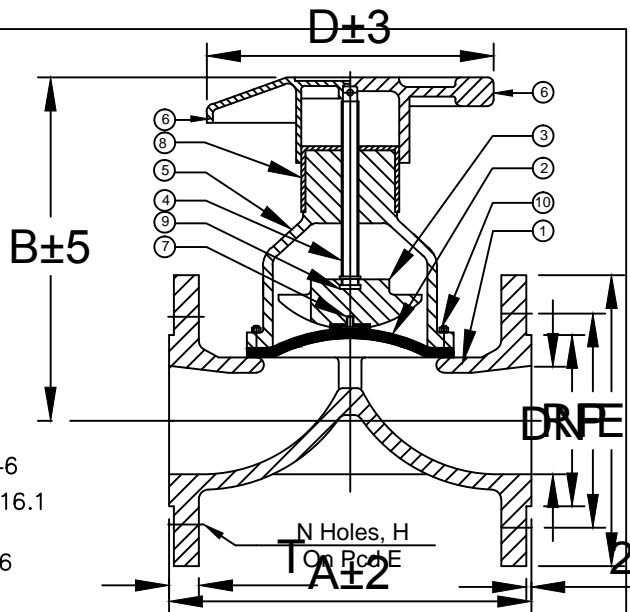

TECHNICAL DATA

- MFG. STD: BS5156
- INSP & TEST STD: BS: 5146
- END CONNECTION ASME B16.1
DRILLED TO 150#
- PRESSURE RATING: PN-16

CAST IRON CASTING GG 25

MATERIAL SPECIFICATION

SN.	COMPONENT	MATERIAL
1	BODY	ASTM A 216 Gr. WCB
2	DIAPHRAGM	PTFE BACKED BY EPDM
3	COMPRESSOR	ASTM A 216 Gr. WCB
4	SPINDLE	AISI 410
5	BONNET	ASTM A 216 Gr. WCB
6	HANDWHEEL*	ABS/S.G.IRON *
7	STUD	BRASS
8	INDICATOR	PP
9	THURSTDISK	MOS2/NYLON
10	FASTENER	M.S.

* 15MM TO 50MM: ABS PLASTIC HANDLE
65MM TO 250MM: S.G.I. HANDLE

Notes :

- DIAPHRAGM :- OTHER ON REQUEST.
- MATERIAL :- OTHER ON REQUEST.

TEST PRESSURE

SIZES	BODY	SEAT
15MM - 50MM	20KG/CM2	15KG/CM2
65MM - 125MM	15KG/CM2	10KG/CM2
150MM-250MM	10KG/CM2	07KG/CM2

DIMENSIONS

DN	A	B	RF	D	E	H	N	P	T
15	108	100	35	60	89	16	4	60.45	11.1
20	118	102	43	60	98	16	4	69.85	11.1
25	127	150	51	78	108	16	4	79.25	11.1
32	146	160	63.5	120	117	16	4	88.9	12.7
40	159	165	73	120	127	16	4	98.55	14.3
50	190	200	92	120	152	19	4	120.65	15.9
65	216	250	105	182	178	19	4	139.7	17.5
80	254	250	127	227	190	19	4	152.4	19
100	305	355	157	271	228	19	8	190.5	23.8
125	356	390	186	375	254	22	8	215.9	23.8
150	406	530	216	375	279	22	8	241.3	25.4
200	521	550	270	482	343	22	8	298.45	28.5
250	635	660	324	510	406	25.4	12	361.95	30



MULTITECH ENGINEERING

L-82, G.I.D.C. Estate, Nr. Water tank Odhav AHMEDABAD - 382415

DRN. : VASUDEV	DIAPHRAGM VALVE (UN-LINED) 150# FLANGED ENDS, 15MM to 250MM
CHD. :	PRESSURE RATING - ANSI 150 #
APD. :	
SCALE : NTS	
DATE :	DRG.NO.:-DV / 150 / 15 to 250 / G.D.