

ALL DIMENSIONS ARE IN MM.

**TECHNICAL DATA**

- MFG. STD: BS5156
- MFG. STD: Revised. BS EN 13397 : 2002.
- INSP & TEST STD: BS: 6755-I
- END CONNECTION : FLANGE,  $B \pm 5$   
DRILL TO PN-10

- PRESSURE RATING: PN10
- SPARK TESTING OF RUBBER LINING AT 10 Kv. AC.  
Shore D hardness : 80-85.

\* 15MM TO 80MM: M.S.  
100MM TO 250MM: S.S.410

\* 15MM TO 50MM: ABS PLASTIC HANDLE  
65MM TO 250MM: S.G.I. HANDLE

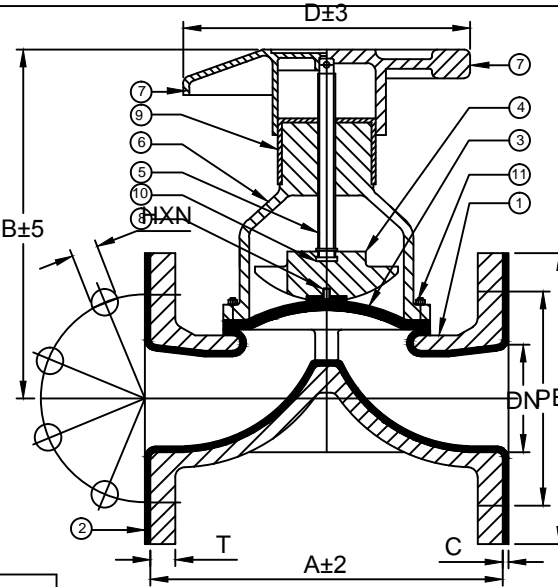

**MATERIAL SPECIFICATION**

| SN. | COMPONENT   | MATERIAL              |
|-----|-------------|-----------------------|
| 1   | BODY        | C.I. / WCB            |
| 2   | LINING      | EBONITE HARD RUBBER   |
| 3   | DIAPHRAGM   | NEOPRENE RUBBER       |
| 4   | COMPRESSOR  | C.I. / WCB            |
| 5   | SPINDLE *   | M.S. / CARBON STEEL * |
| 6   | BONNET      | C.I. / WCB            |
| 7   | HANDWHEEL * | ABS/S.G.I. *          |
| 8   | STUD        | BRASS                 |
| 9   | INDICATOR   | PP                    |
| 10  | THURSTDISK  | MOS2/NYLON            |
| 11  | FASTENER    | M.S.                  |

**DIMENSIONS**

| DN  | A   | B   | C | D   | E   | H  | N  | P   | T  |
|-----|-----|-----|---|-----|-----|----|----|-----|----|
| 15  | 108 | 100 | 3 | 60  | 95  | 14 | 4  | 65  | 14 |
| 20  | 118 | 102 | 3 | 60  | 105 | 14 | 4  | 75  | 16 |
| 25  | 127 | 150 | 3 | 78  | 115 | 14 | 4  | 85  | 16 |
| 32  | 146 | 160 | 3 | 120 | 140 | 18 | 4  | 100 | 18 |
| 40  | 159 | 165 | 3 | 120 | 150 | 18 | 4  | 110 | 18 |
| 50  | 190 | 200 | 3 | 120 | 165 | 18 | 4  | 125 | 20 |
| 65  | 216 | 250 | 3 | 182 | 185 | 18 | 4  | 145 | 20 |
| 80  | 254 | 250 | 3 | 227 | 200 | 18 | 8  | 160 | 22 |
| 100 | 305 | 355 | 5 | 271 | 220 | 18 | 8  | 180 | 24 |
| 125 | 356 | 390 | 5 | 375 | 250 | 18 | 8  | 210 | 26 |
| 150 | 406 | 530 | 5 | 375 | 285 | 22 | 8  | 240 | 26 |
| 200 | 521 | 550 | 5 | 482 | 340 | 22 | 8  | 295 | 26 |
| 250 | 635 | 660 | 5 | 510 | 395 | 22 | 12 | 350 | 28 |

Notes :

- LINING :- OTHER ON REQUEST.
- DIAPHRAGM :- OTHER ON REQUEST.
- MATERIAL :- OTHER ON REQUEST.

**TEST PRESSURE**

| SIZES        | BODY     | SEAT     |
|--------------|----------|----------|
| 15MM - 50MM  | 20KG/CM2 | 15KG/CM2 |
| 65MM - 125MM | 15KG/CM2 | 10KG/CM2 |
| 150MM-250MM  | 10KG/CM2 | 07KG/CM2 |



**MULTITECH ENGINEERING**

L-82, G.I.D.C. Estate, Nr. Water tank Odhav AHMEDABAD - 382415

|                |   |
|----------------|---|
| DRN. : VASUDEV | DIAPHRAGM VALVE (LINED) PN-10<br><b>FLANGED ENDS, 15MM to 250MM</b> |
| CHD. :         | PRESSURE RATING - PN-10   |
| APD. :         |   |
| SCALE : NTS    |   |
| DATE :         | DRG.NO.: <b>DV / PN-10 / 15 to 250 / G.D.</b>                       |